

BAT B

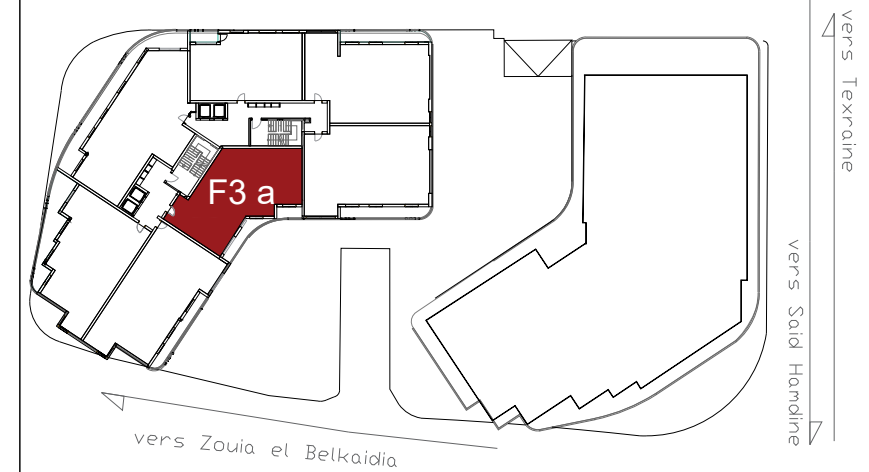

Batiment B

Surface utile : 135.76m²

Terrasse	14.51m ²
Séjour	22.91m ²
Cuisine	24.80m ²
Chambre 1	29.58m ²
Chambre 2	15.39m ²
SDB	4.10m ²
Hall	6.45m ²
circulation	13.15m ²
Rangement	2.27m ²